



Lauren Grove

Lauren Grove is a charming 43± acre Southern Pecan Farm. Located just north of Statesboro, GA off Clito Road on Cliponreka Road. This Bulloch County farm features a stunning 20± acre Pecan Orchard with beautiful 80 year old actively producing trees. There are about 150 trees on the property with 70x70 spacing. The variety of trees are stewarts, frothers, and seedlings with 60-65% being stewarts. The remaining 20+ acres of the property is in timber regeneration and is bordered to the east by a branch. There is also an old home place on the property with a well in place. The calm serenity of Lauren Grove is just right for those seeking to relax from all the hustle and bustle, however being only 10 minutes from town still makes this farm convenient to all the local amenities the charming town of Statesboro, GA has to offer. This property has several gorgeous home sites; or create the perfect family farm, weekend get-away in the country or investment opportunity. Let us know if you would like to take a look!! 912.764.(LAND)5263



Price: \$200,000

Property Type: Land

Status: Sold

Street/Address: 1309 Cliponreka Road

City: Statesboro

State: Georgia

Zip code: 30461

County: bulloch

Acreage: 43

Per Acre Price: \$0.00

Phone Number: 912.764.LAND(5263)

Email: info@landanddrivers.com

Google Maps link: [View Larger Map](#)

Lauren Grove

Published on Plantation Properties & Land Investments, LLC (<https://www.landandrivers.com>)

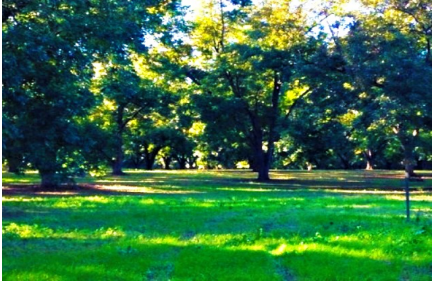
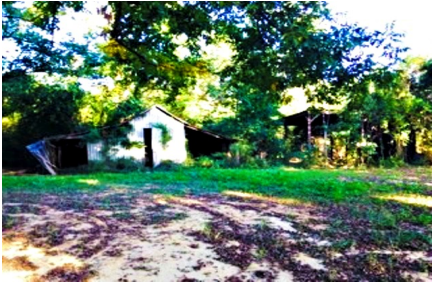

Topo Map

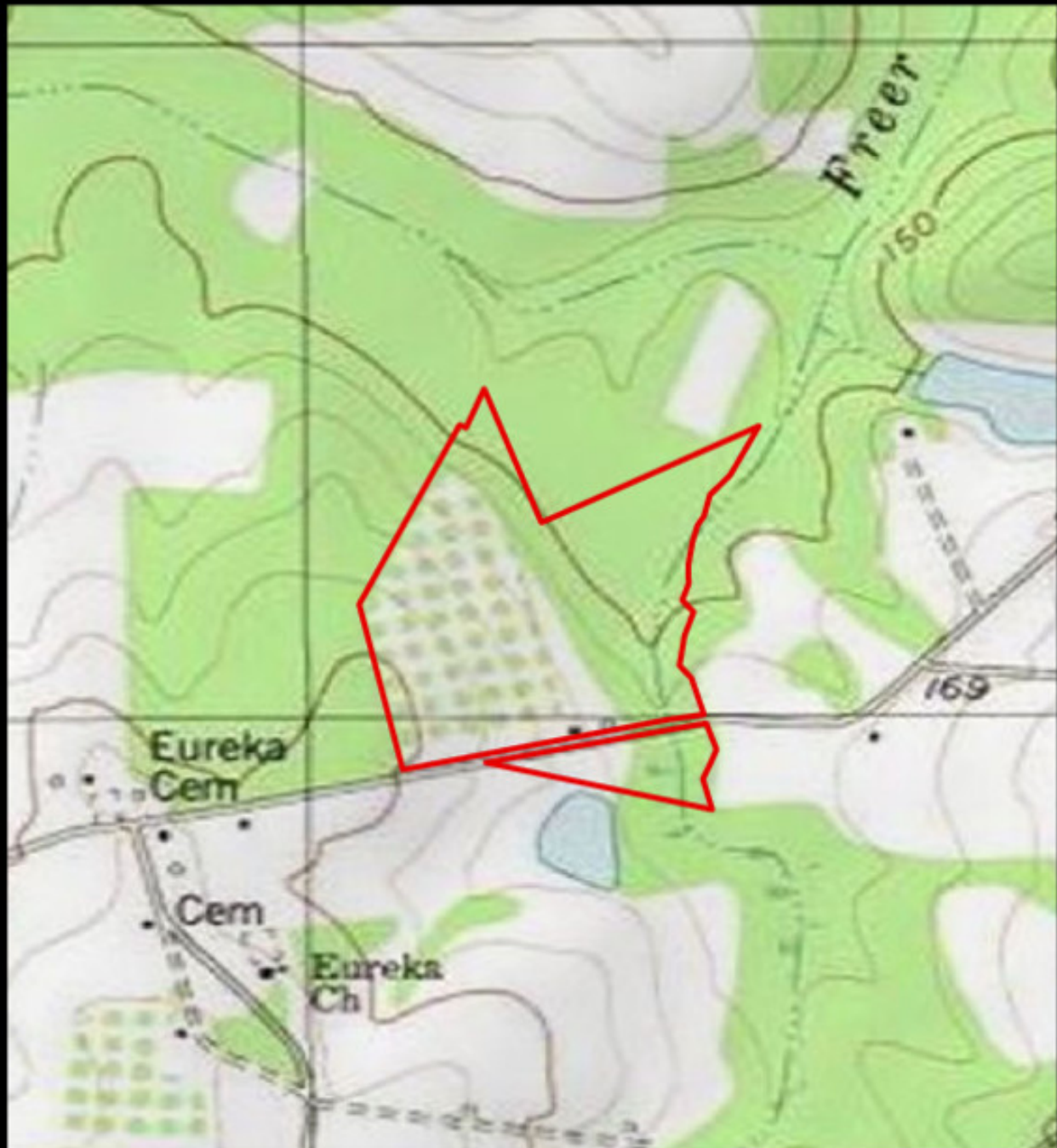

**PLANTATION PROPERTIES
&
LAND INVESTMENTS, LLC**

1782 Riverbank Way, Suite 101 | Statesboro, GA 30458
912.791.LAND (52637) | 706.726.5638
Jill and William
*This document is not to be distributed or reproduced
www.landanddrivers.com
P 7117

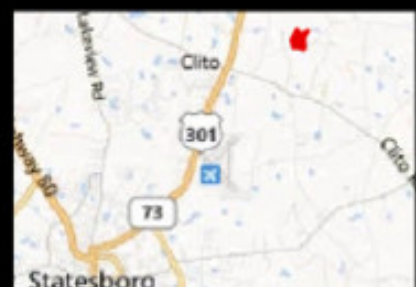

Aerial Map

Lauren Grove

Published on Plantation Properties & Land Investments, LLC (<https://www.landandrivers.com>)



Location Map

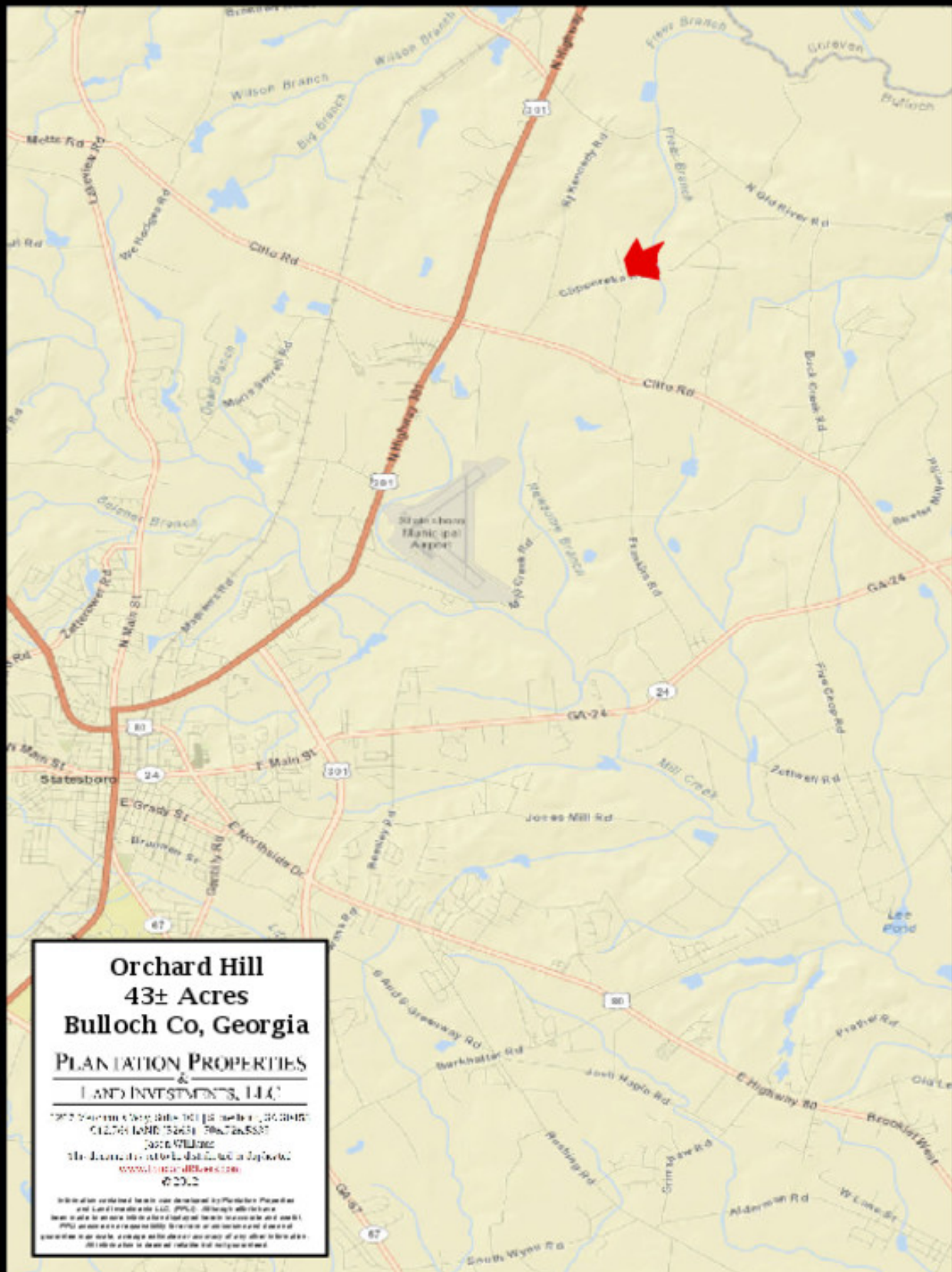

Source URL: <https://www.landanddrivers.com/property/lauren-grove>