



Kareehoek Estates

One of the finest Horse and Cattle farms in South Georgia. This ranch offers a custom designed main house, bunk house, horse barn, riding arena, working pens, a machine shop and more. This is an extremely well maintained property that requires little or no additional input. The newly built brick main house, of true southern charm consists of approximately 4,000 square feet features 4 bedrooms, 3 baths and a spacious beautiful kitchen with lots of storage. The open floor plan creates a feeling of spaciousness while a vast great room with full windows gives you stunning views of this gorgeous farm. This home is ideal for a family of any size or would be perfect for a multi-family get-away in the country. The quiet seclusion is just right for those seeking to relax from all the hustle and bustle. The bunk house features a full kitchen and living area with a breezeway and stud stall that connects to a separate pasture area. The main 60 x 90 horse barn is centrally located with the riding arena on the southern side and 3 working pens to the north. This barn features 6 stalls with separate fenced runs/turnouts. This beautiful farm features 2 nice ponds; one is 2+/- acres and the other being 3+/- acres. The ranch consists mainly of rolling pastures and open land which has been fenced and cross fenced. Could easily sustain upwards of 100 head of cattle. A true private and peaceful working ranch. Conveniently located between Savannah and Augusta, only 20min from Statesboro and Georgia Southern University. What a better place to call home, horse ranch, cattle operation or even as a quick retreat from the hustle of urban living? This is a well managed exceptional property. A MUST SEE!!!

Property is currently being leased out for cattle so no worries if you think you may not have enough livestock to warrant a dream farm like this, there are plenty of folks willing to lease a portion or the entire farm.



Price: \$899,000

Property Type: Land

Kareehoek Estates

Published on Plantation Properties & Land Investments, LLC (<https://www.landanddrivers.com>)

Status: Sold

Street/Address: 5391 Big Pine Road

City: millen

State: Georgia

Zip code: 30442

County: jenkins

Acreage: 190

Per Acre Price: \$0.00

Phone Number:

Email:

Google Maps link: [View Larger Map](#)



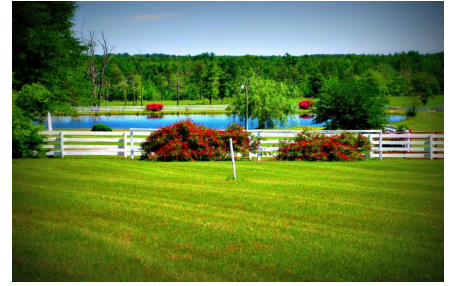

Aerial



**PLANTATION PROPERTIES
&
LAND INVESTMENTS, LLC**

12174 Warfield Rd., Suite 100 | Statesboro, GA 30428
912.364.1610 | (706) 726.5638
JASON WILLIAMS
This document is not to be distributed or duplicated
www.LandandDrivers.com
© 2019



Aerial 2 (zoomed in)



**PLANTATION PROPERTIES
&
LAND INVESTMENTS, LLC**

12174 Warfield Way, Suite 100 | Statesboro, GA 30428
912.364.1611 | 706.725.5638
JASON WILLIAMS
This content is not to be distributed or duplicated
www.LandandRivers.com
© 2017



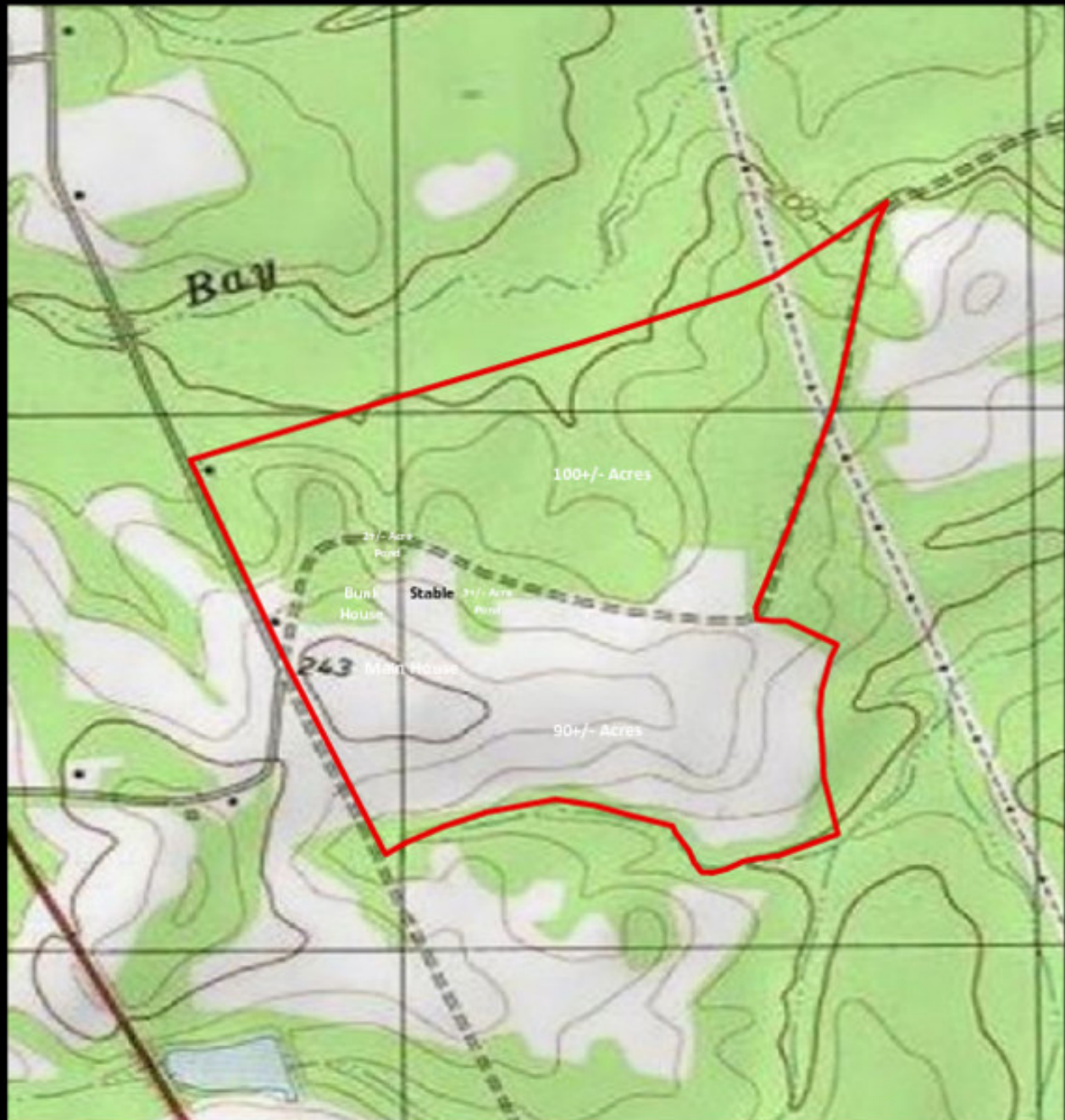

**PLANTATION PROPERTIES
&
LAND INVESTMENTS, LLC**

12174 Wardle into Way, Suite 100 | Statesboro, GA 30428
912.304.1410 | (706) 726.5638
JASON WILLIAMS
This document is not to be distributed or duplicated
www.LandandRivers.com
© 2019



Location

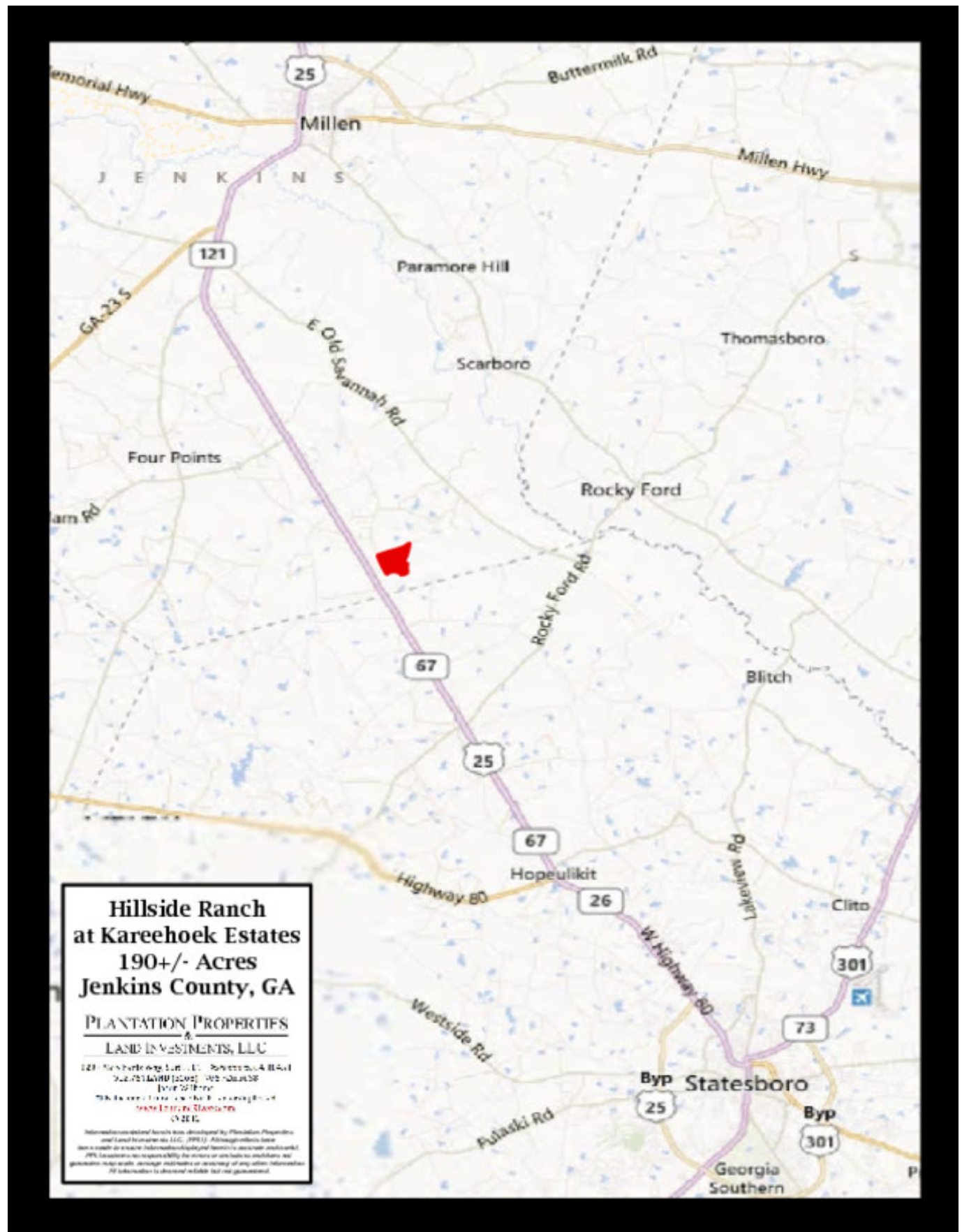

Source URL: <https://www.landanddrivers.com/property/kareehoek-estates>