



## **Burkhalter Road**

28± acres of open cultivated land located in the Southeast Bulloch school district. This property is only 8 miles from downtown Statesboro and only 52 miles from Savannah, GA. With paved road frontage along Burkhalter Road, this property would make a great home site or could be developed into a subdivision. Call today to schedule a time to see this property! 912.764.LAND(5263)



**Price:** \$250,000

**Property Type:** Land

**Status:** Sold

**Street/Address:** Burkhalter Rd

**City:** Statesboro

**State:** Georgia

**Zip code:** 30461

**County:** bulloch

**Acreage:** 28

**Per Acre Price:** \$8,929.00

**Phone Number:** 912-764-LAND(5263)

**Email:** [info@LandandRivers.com](mailto:info@LandandRivers.com)

**Google Maps link:** [View Larger Map](#)

## Burkhalter Road

Published on Plantation Properties & Land Investments, LLC (<https://www.landandrivers.com>)

---



## Aerial Map



## Burkhalter Road

Published on Plantation Properties & Land Investments, LLC (<https://www.landanddrivers.com>)

28+/- acres on Burkhalter Rd.  
Duluth County, Georgia AC +/-



Jason Williams  
P. 512-791-LAND(5263) or 1-855-GOT-LAND (438-6263)

[info@landanddrivers.com](mailto:info@landanddrivers.com)



## Location Map

## Burkhalter Road

Published on Plantation Properties & Land Investments, LLC (<https://www.landanddrivers.com>)

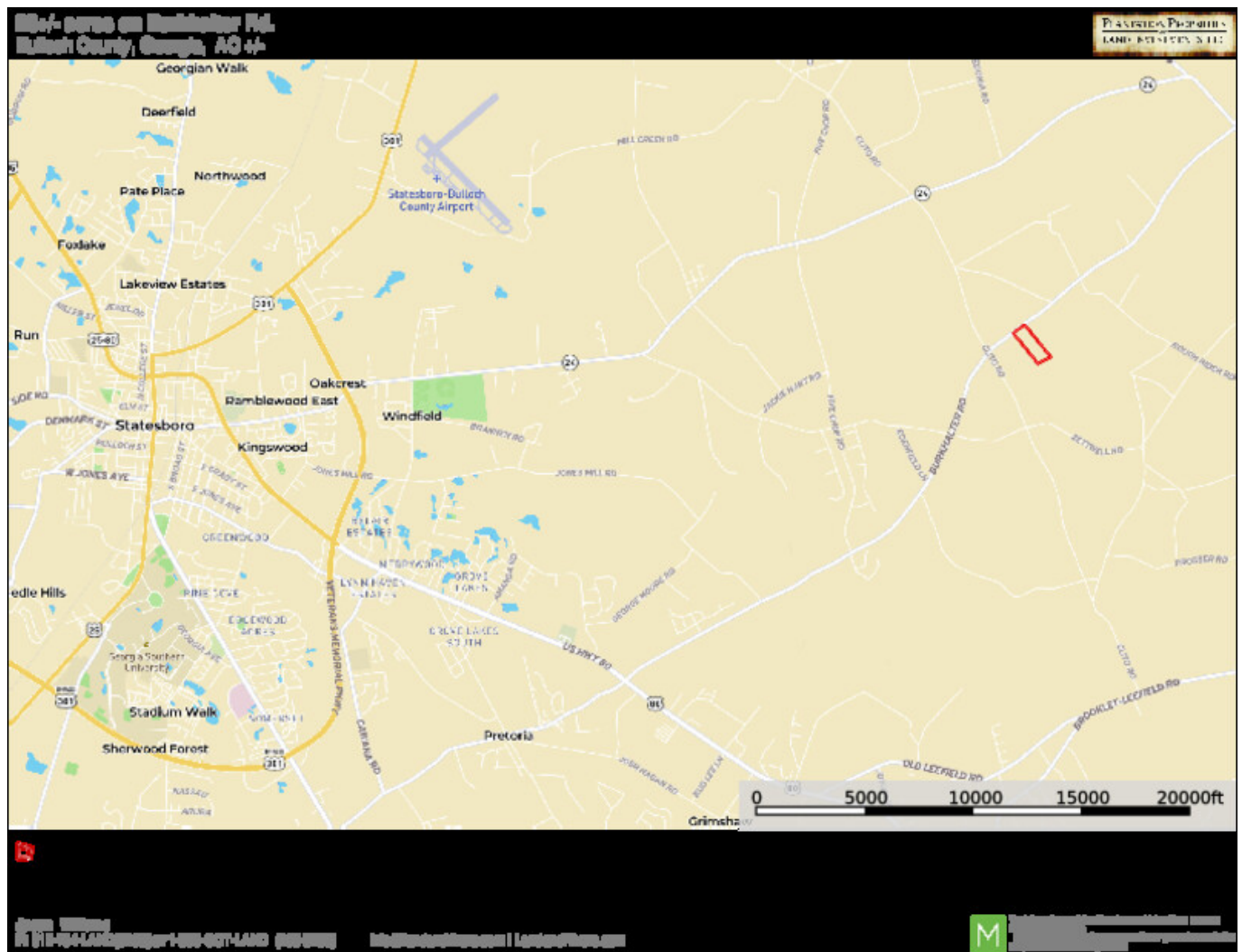

## TOPO Map



## Burkhalter Road

Published on Plantation Properties & Land Investments, LLC (<https://www.landanddrivers.com>)

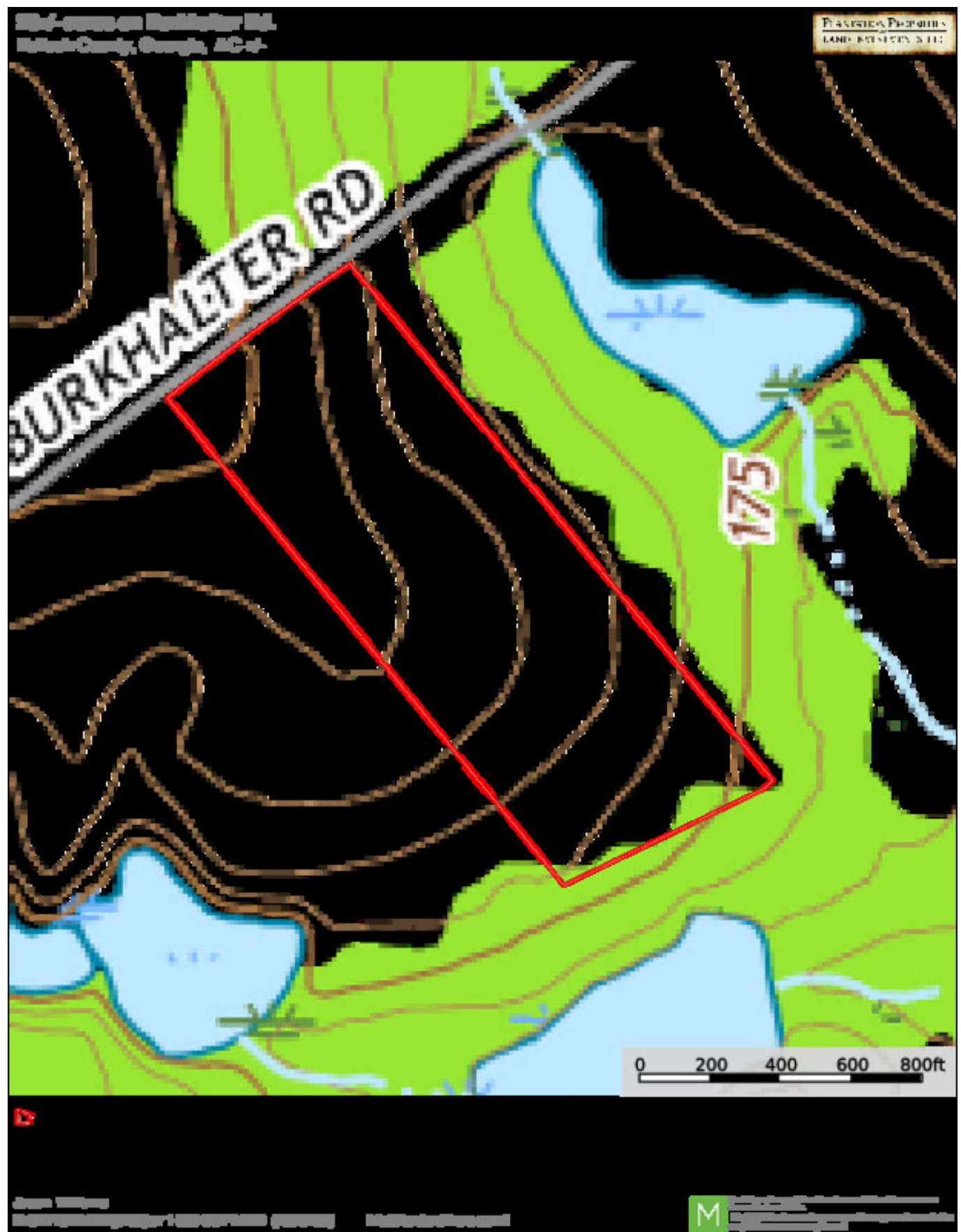

Source URL: <https://www.landanddrivers.com/property/burkhalter-road>